

52 Rektangulære bord = 355 gjester

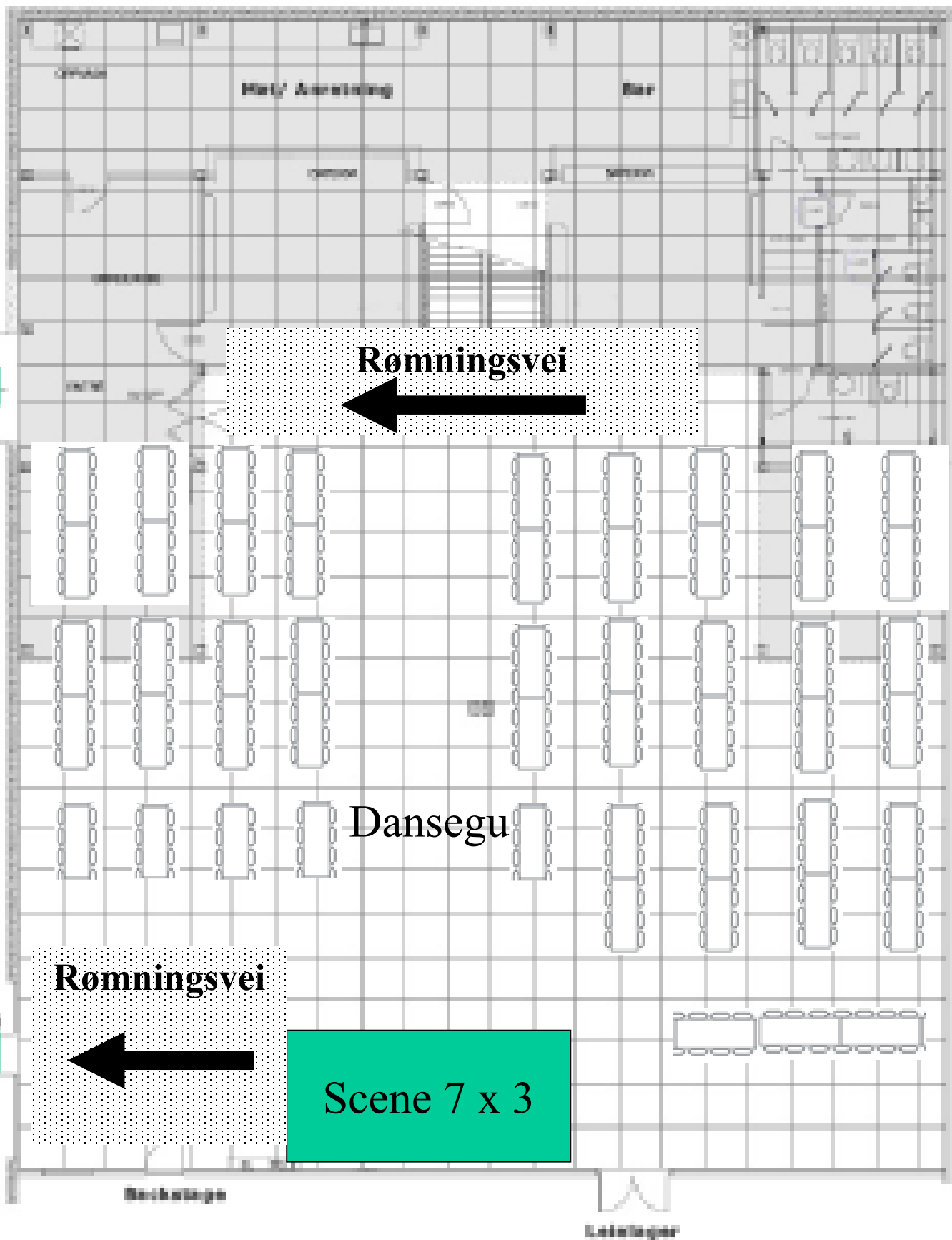

26 stk 8-manns bord - 1.etg = 208/ 234 gjester

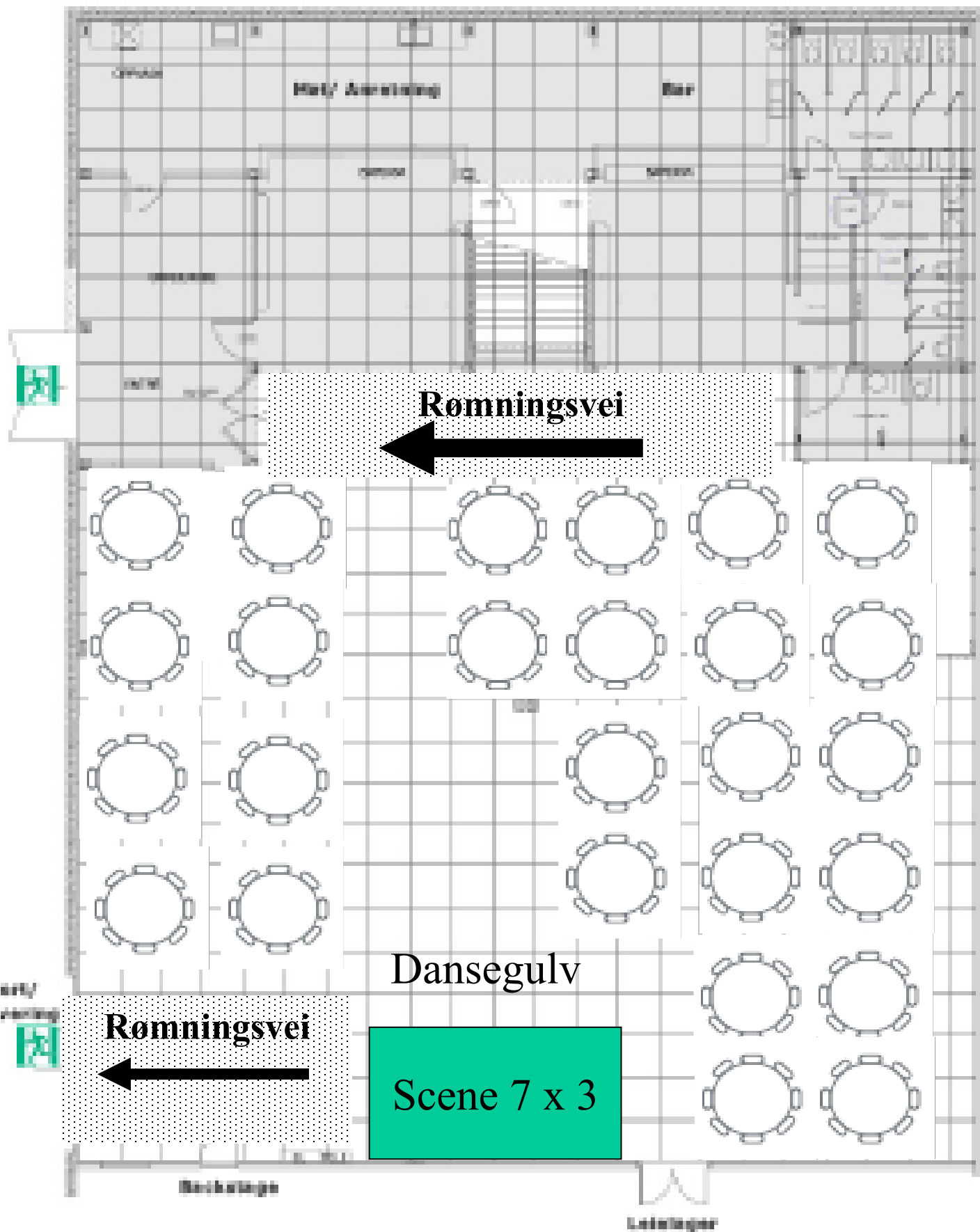

58 STK Rektangulære bord – 1. etg = 272 / 328 gjester

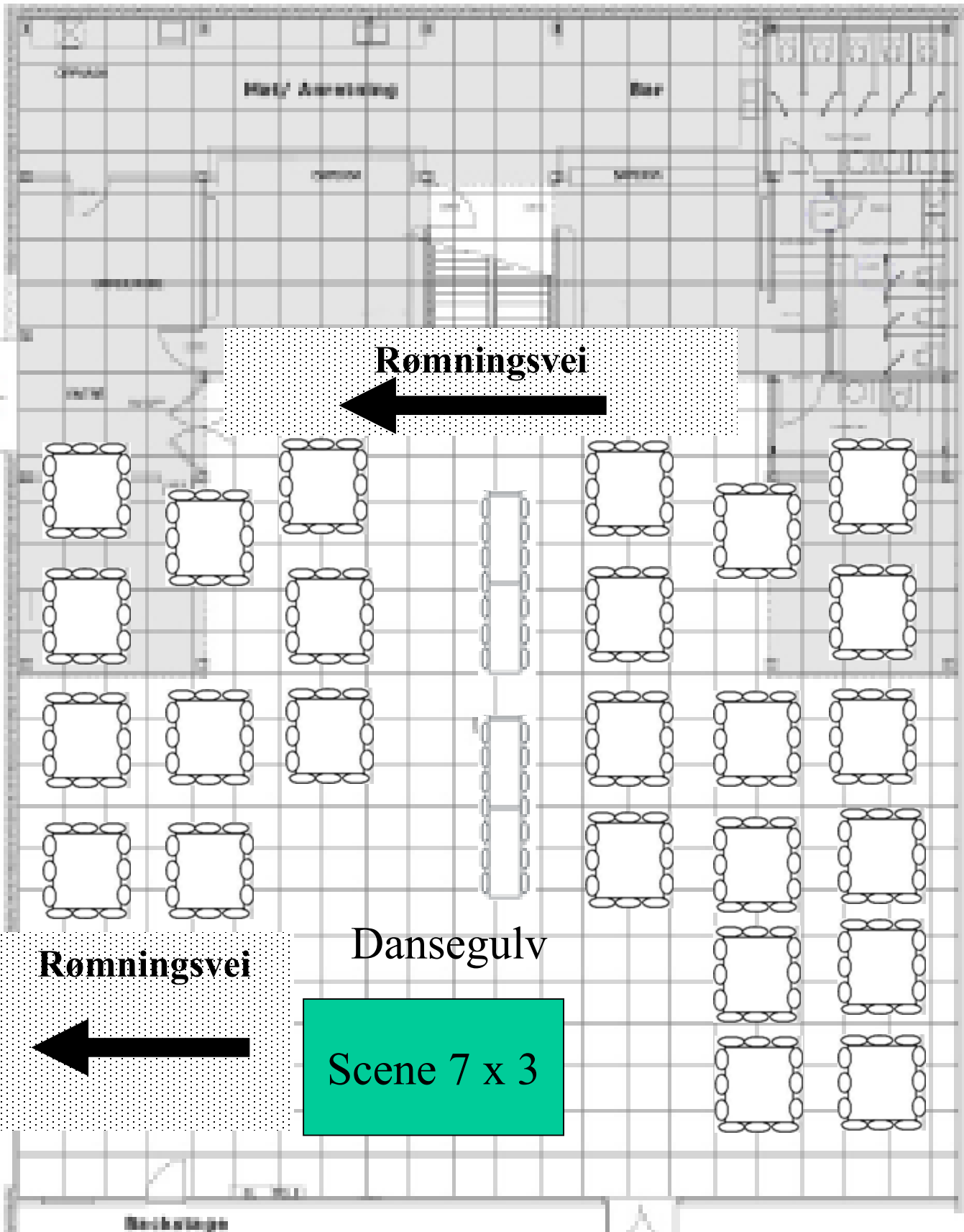

31stk 6-manns bord + 9 stk 8-manns bord

1. etg = 259 / 298

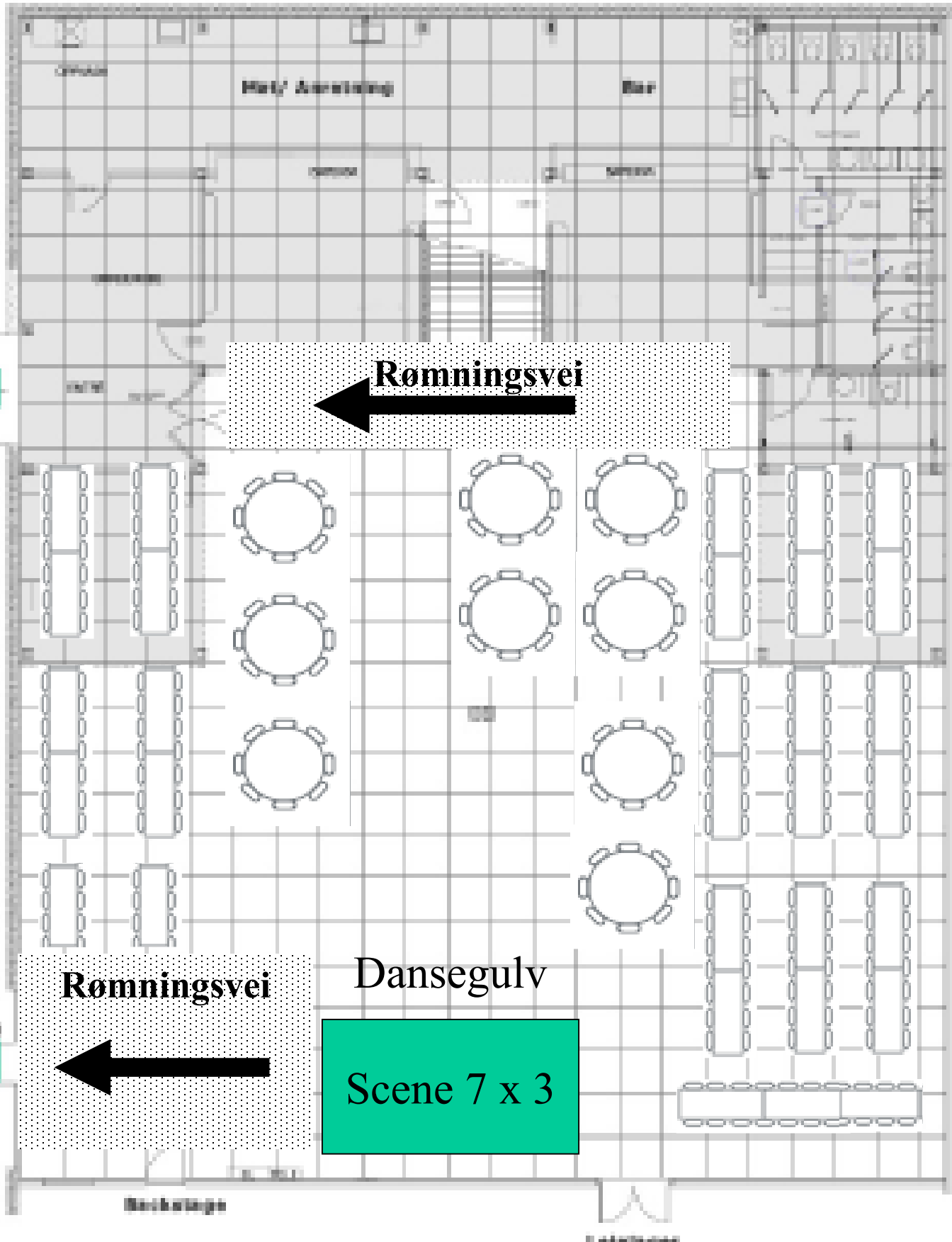

53x Rektangulære bord = 296/348 gjester

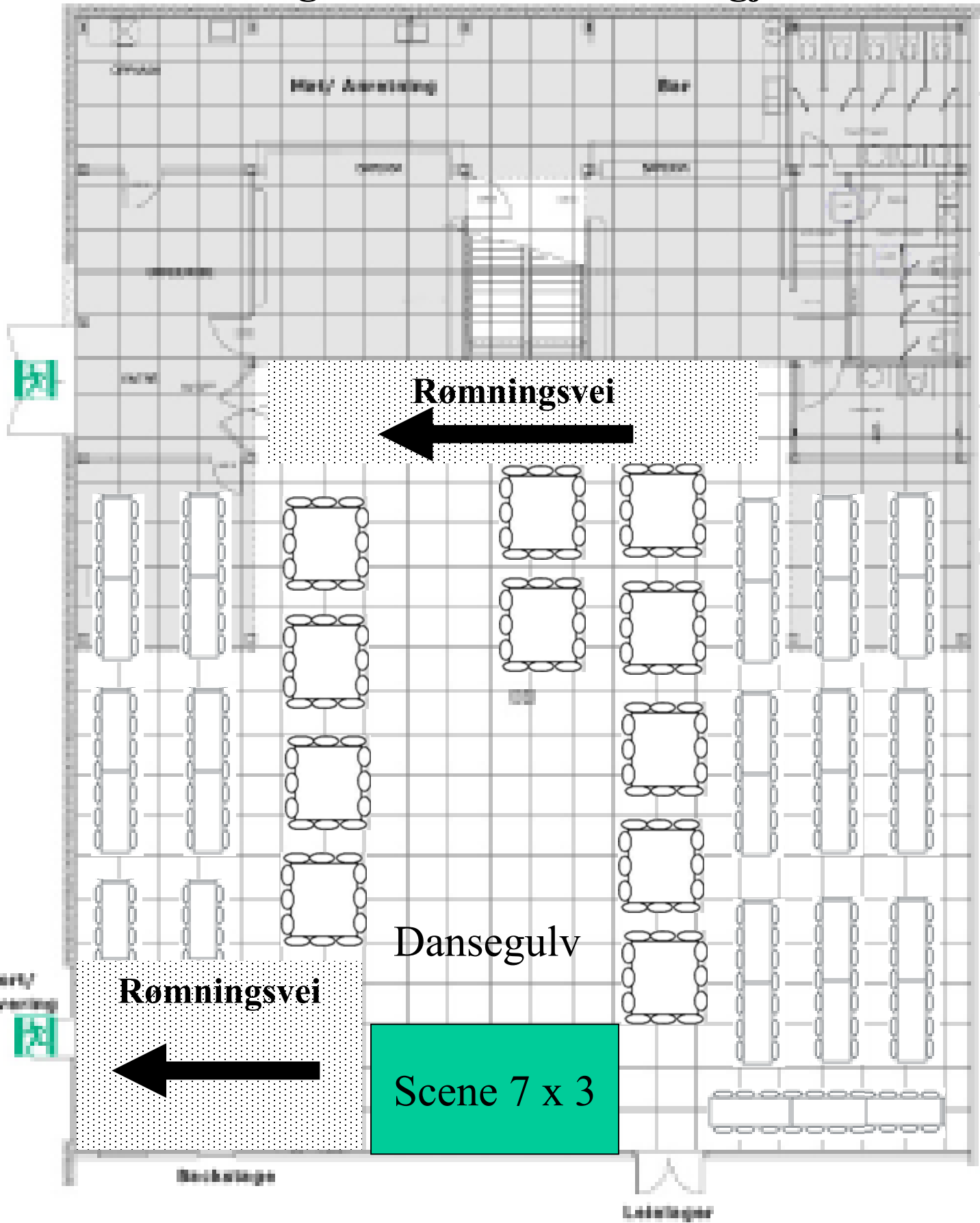

15 Rektangulære bord + 10 - 8-manns bord = 230/270 gjester

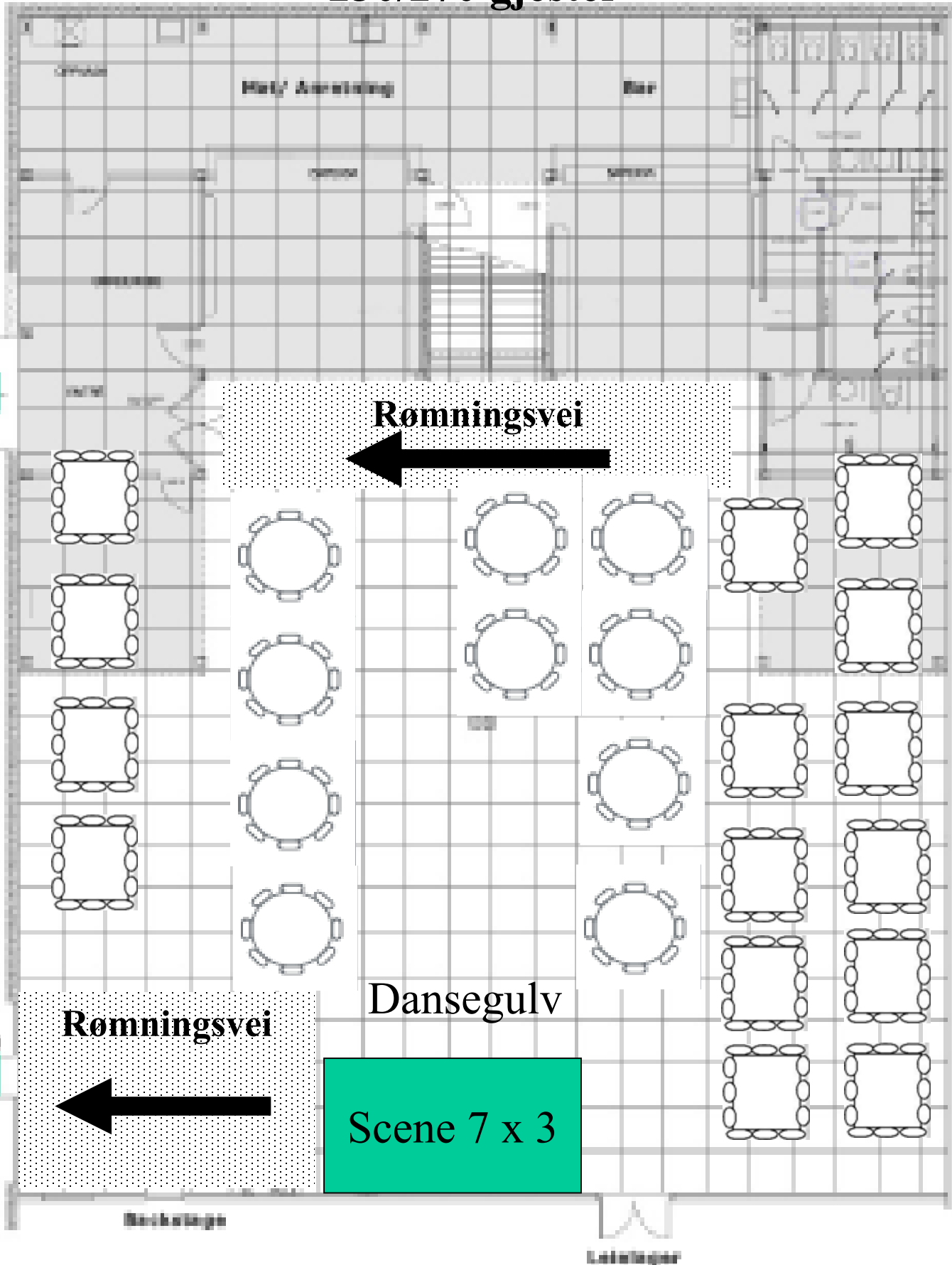

20 Rektangulære bord -12 mannsbord = 120 Gjester

